



tripwire

Golden Edition



Issue 50 January/February 2009

MAGAZINE OF THE R.T.P.I. WEST MIDLANDS

RTPI President attends 3rd West Mids 'Great Debate'

The West Midlands 'Great Debate', hosted by Arup, is fast becoming the 'built environment event of the year'. Ably chaired this year by Richard Moxon, Chair of RICS England, the Panel from the RTPI, RIBA, RICS, ICE and HCA (the new Homes & Communities Agency) fielded a broad range of challenging questions from a packed audience in the Nyquist Theatre at Arup's impressive Blythe Valley complex.

It may be a depressing sign of the times, but many of the topics focused on the effects of the credit crunch and the ever deepening recession. But the 5 strong 'team' kept the audience up-beat, interested and entertained throughout the event.

Martin Willey, our own RTPI President, on his first regional visit, tackled the issue of skills in the planning profession head-on, emphasising the need for local authorities to use the economic slowdown to focus more resources on forward planning to deliver more LDF's.

Paul Spooner, the new Regional Director of the HCA underlined the importance of delivering more new housing and highlighted the various Government initiatives to deliver affordable housing at a time when many people are finding it difficult to get a foot on the housing ladder.

Louise Brooke-Smith, West Midlands RICS Board Member, referred to the Lyons Review in looking at ways of moving out of recession, which recommended the decentralisation of employment to the regions. Louise had some positive ideas for new activities, such as distribution, the education economy and 'green industries'. Later, in addressing the problems of the planning system, Louise also advocated the findings of the Killian Pretty Review in speeding up the process.

In exploring how the planning system can cope against a backdrop of falling land values, David Johns from ICE reminded us that build costs have barely changed whilst landowners and developers now get much less return from the land - suggesting that something will have to give. John Christophers from the RIBA, commented that 'Cities are living organisms - we are looking at a shifting picture'.

On the day when the legal challenge against the Government's Eco Towns consultation failed, none of the team were inspired by the prospect of new Eco Towns in our region. Most felt that the future lay in regenerating urban areas and invigorating our towns and cities - a positive message perhaps for our Regional Assembly as they lead in to Regional Spatial Strategy examination. 



Editor - John Acres, Ripon Cottage, 5 Manor Road, Kilsby, Near Rugby, Warks, CV23 8XS
Work: 01789 203800 • Home: 01788 824343 • Email: acresclark@lineone.net

Inside

Chair's remarks	2
Robert Upton awarded CBE in New Years Honours list	2
CPRE raises concerns about Govt Office impartiality	3
Legal Challenge to Government's Eco Towns initiative fails	3
The Value Added by Urban Design to Development and Regeneration.	4
Reflections After Three Decades of Planning	5
West Midlands Pilots APC Support Pack for Employers	6
New Regional Manager for Planning Aid	6
CPD Events	7

Book up for the Ball:
Friday 13th March 2009

Chair's remarks

Happy New Year. A week ago, like many people, I was reading about the life of Barack Obama. What an amazing individual he is and what hope he brings. His direct experience and commitment to engaging with deprived and disparate communities, to empowering them to work together to find areas of agreement and then secure the necessary changes to their communities, was inspiring. His view that government decisions should be transparent, based upon the best available evidence and open for consultation is a significant change in approach for the US. He truly believes in climate change and the need to act (he drives a hybrid Ford), has read every Harry Potter book and would like to have been an architect if he were not a politician. Somehow the start of 2009 had a positive feeling and there seemed to be a new hope - here was someone who we could believe in and who held many of the ideals of the RTPI for a sustainable and equitable society - perhaps we should make him an Honorary member?



The other new president who has just taken office is Martin Willey. In his first week in office he managed to find time to come up to the region to represent the RTPI at the 3rd annual Great Debate, and was an excellent panelist. Martin has a clear view as to how he sees the RTPI moving forward over the next year and believes that the greatest challenge facing planners today concerns climate change and sustaining the relevance and importance of professional planners in delivering solutions. The Great Debate, which this year was chaired by the RICS, was a huge success with over 170 places taken and latecomers turned away. On many issues it became clear that the RTPI, RIBA, ICE and RICS were speaking with one voice. Most importantly all recognised that they had a role to play in delivering the upturn and that in doing so we must learn from past mistakes and ensure that new development embraces sustainable and high quality designs.

Two positive and inspiring presidents and a successful event.....then suddenly it was back to reality again. Times will get tough over the next year

as the recession bites. The IMF has just stated that it believes the UK economy will be more badly affected than that of other developed nations. So what does this mean for planners in the West Midlands? We are already seeing redundancies in both the public and private sectors as organisations endeavour to restructure for survival. In response to the economic downturn, the RTPI has developed guidance to support members facing uncertain times, and if you are concerned or affected I would recommend you take a look what is on offer from our Institute at www.rtpi.org.uk.

What can planning offer in times of recession? I believe that we can offer hope. We have the ability to look to the long term, to understand what is needed to support and guide recovery and to put in place strategies to ensure that when we come out of this recession we are well placed for a strong recovery. Looking to the future the region is committed to raising the profile of the profession and ensuring that we attract the brightest and the best of our future graduates - after all who would want to be a banker now?

Finally, I would like to congratulate John Acres, the editor of Tripwire on producing an amazing 50 editions of the magazine. John - what would we do without you? John produces six editions of Tripwire each year in his own time, which are widely read across the region - indeed many planners have commented that this is how they connect with the region and feel a part of the RTPI. On behalf of all RTPI planners in the West Midlands region, and our extensive 'non planning' readership, I would like to express our heartfelt thanks to you, John for the work you have done in producing Tripwire - the best RTPI regional magazine.

Finally, I look forward to seeing you all at the RTPI West Midlands Ball on 13th March 2009 - the event of the year! (Ed: Please see the poster at the back of this edition.) 

Sue Manns
Regional Chair

Robert Upton awarded CBE in New Years Honours list

We are delighted to report that Robert Upton, the Secretary General of the RTPI has been awarded a CBE in the New Years Honours list for public service.

In learning of the announcement, Robert Upton said 'I see this as a recognition of what the RTPI as a whole, both volunteers and staff, have achieved over a period of great change in planning'.

Sue Manns, our Regional Chair wrote to Robert to express our congratulations on behalf of the RTPI West Midlands region. 'We offer you our warmest congratulations on your CBE' she said 'I know that the news will be welcomed by planners across the West Midlands, who will feel inspired by your achievements for the profession'. In responding to Sue Manns, Robert replied 'Here's to the future which will be no less challenging for us all.' 

CPRE raises concerns about Govt Office impartiality

The Campaign to Protect Rural England has sought reassurance from the Examination Panel investigating the West Midlands Regional Spatial Strategy (RSS) that they will not be unduly swayed by the consultation response from the Government Office seeking the higher levels of housing provision floated in the Nathaniel Lichfield report.

In a series of controversial exchanges at the Pre examination meeting of the forthcoming RSS revision held on 27th January at the Molineux Stadium in Wolverhampton, Peter Langley (Vice Chair of West Midlands CPRE – and himself a former GOWM Planning Director) argued that the Government Office response to the Submitted RSS, goes well beyond normal practice in supporting a fixed position and taking dogmatic views – including specific wording changes - without taking into account the opinions of other organisations. This will make it more difficult for the Panel to reach an independent approach and for the Secretary of State to ultimately reach a fair and impartial decision, CPRE claim. 'Are we all wasting our time if they have already made up their minds', he said.

However, the Panel Chairman, Alan Richardson, also a former DOE Director, welcomed the Government Office report in clarifying Government policy but reassured the meeting that the Panel would indeed take a fair, independent and impartial view. He said the Panel would not 'rubber stamp' any proposals but would come to what they believe to be the right conclusions.

Speaking for the Government Office, Ian Smith also assured the CPRE that they were simply explaining their position within the context of the Government's clear housing policies and were asking the Panel to explore and consider a range of options.

The Regional Assembly clearly shared the CPRE's deep seated concern and harked back to the intervention by Baroness Andrews a year ago that triggered the

Government Office study. Mark Middleton complained that the Government's intervention had wasted 9 months of everybody's time and forced the WMRA to make representations on their own plan. He said he took comfort from the independence of the Panel, but did not wish to see any further delay and was anxious to see the Phase 2 revision adopted before the Assembly is disbanded by April 2010. Above all, the Regional Assembly did not want to see a policy vacuum created.

It also emerged that although Phase 2 of the Revision would be completed before the new Regional arrangements come into force, Phase 3 would almost certainly be handled under the new provisions for Integrated Regional Strategies, currently being considered by Parliament in the Local Democracy, Economic development and Construction Bill.

There will also be further work on the Habitat Regulations Assessment to assess the impact of any higher levels of development, following representations from the RSPB and others. 'This is very important', the Panel Chairman said, 'It's not rocket science, it's even more uncertain than that!'

A day long Housing seminar, staged on 28th January - the following day - then looked in more depth into the debate about housing numbers – exploring the NHPAU advice, the Nathaniel Lichfield Report, the recently published Arup report on Housing & Employment and work undertaken by Alan Wenban-Smith examining the perceived risks to the current Urban Renaissance strategy from higher housing numbers.

After two days of intensive introductions, presentations and discussions, few people were left in any doubt that, whether this is a revision or a review, this is indeed going to be a fascinating regional debate. The second EiP Preliminary Meeting will be on the 18 March and the Examination in Public itself will open on 28th April. 

Legal Challenge to Government's Eco Towns initiative fails

A High Court Challenge against the Government's Eco Towns programme has been dismissed by Lord Justice Walker on all grounds. The campaign group, BARD, ('Better Accessible Responsible Development') which has been active in resisting the proposals for a 6000 dwelling Eco Town at Long Marston in south Warwickshire, had lodged a case against the Government's consultation arrangements for Eco Towns.

The group claimed that there had been a failure to consult the public properly about the new proposals for new 'eco friendly' towns. However, the Chairman of the protesters, David Bliss, said after the ruling 'We are disappointed, but this is

by no means the end of the road for Bard's challenges to the Middle Quinton proposal'.



Commenting on the outcome, Mark Sitch, Partner of Barton Willmore who have been promoting the Middle Quinton proposal on behalf of the landowners said 'We are pleased that the ruling has gone in the Government's favour and we look forward to hearing the decision on the final Eco Town shortlist in the coming months'.

The draft Planning Policy Statement on Eco Towns is still out for consultation and, subject to any appeal, will now presumably now progress to becoming a fully fledged PPS document. 

The Value Added by Urban Design...

A first hand report of the Conference held at Wolverhampton Science Park.

This inter-disciplinary conference was organised jointly by the University of Wolverhampton and the West Midlands Centre for Constructing Excellence. Its aim was to enable key players in the development industry to debate the merits of the 'added value' of urban design - and how to deliver it in the context of the current recession.

Participants were welcomed by Professor Caroline Gipps, Vice Chancellor of the University of Wolverhampton. She pointed out the widespread ignorance and misunderstanding about Urban Design. She felt it is not so much what development looks like, but more about how well it is put together, how it functions and whether it fulfils our needs, whether economic, social or cultural.

In my introduction as Chair, I recalled the re-discovery of the almost forgotten discipline of urban design since the 1960's and the many remarkable schemes which have taken place since - and yet, how the vast majority of development being permitted and built ranges from the mediocre to the appallingly poor.

Julia Ellis, Chief Executive of MADE, the West Midlands Architecture Centre, spoke of their enabling, educational and promotional role in improving the quality of the designed environment which enhances the quality of life of people living and working in the region and encourages economic success. She outlined, with examples, various aspects of 'value' in design: exchange, use, image, social, environmental and cultural value.

Nathan Cornish, Managing Director of Urban Splash (Midlands), outlined the ground-breaking approach of his company to design quality and value generation, illustrated through their current schemes. The imaginative mix of old and new was clear and the creation of new markets and value remarkable. Urban Splash was born in a recession, so there are still amazing opportunities out there.

Philip Singleton, Acting Assistant Director City Development and Design, Birmingham City Council, explained his Authority's approach to urban design by reference to the 'Big Plan' for the City Centre. Their aspiration is to establish Birmingham as a 'World City', massively expanding the City Centre and linking it to its hinterland. He advocated a "sustainable urbanism" approach where 'design is value'.

Greg White, Executive Director, Connolly & Callaghan Investments, thought that recent asset values had been based on how they could be funded and not on property fundamentals, hence the current problems. In order for urban design to 'add value' to development it ought to rigorously address the problems of 'Obsolescence': functional, economic, legal, social, environmental. 'Resilience' was the key word, he said.

Sandra Roebuck, Principal EDAW (London), showed how urban design was used to turn around the under-performing town centre of Hounslow through community and stakeholder involvement and city pride. The town centre core was re-defined, barriers addressed, linkages to the hinterland forged, new development opportunities identified and the quality of the public realm and life in general was enhanced.

Stephen Catchpole, Chief Executive Wolverhampton Development Company, spoke about regeneration. The importance of urban design could be seen in differentiation and attractiveness and brought long-term benefits. A Master Plan Framework to encompass the City Centre and the A449 regeneration corridor to the north had been prepared. The aspiration was to attract £1 billion investment, create 2 million sq ft of office floorspace and 30,000 jobs by 2031, through private sector and community engagement. High quality urban design was an important part of the strategy.

The Q&A session brought out important ideas. Admittedly the 'unconvinced' had not attended the conference nor had their views been heard. Volume housebuilders are in crisis in this recession and the

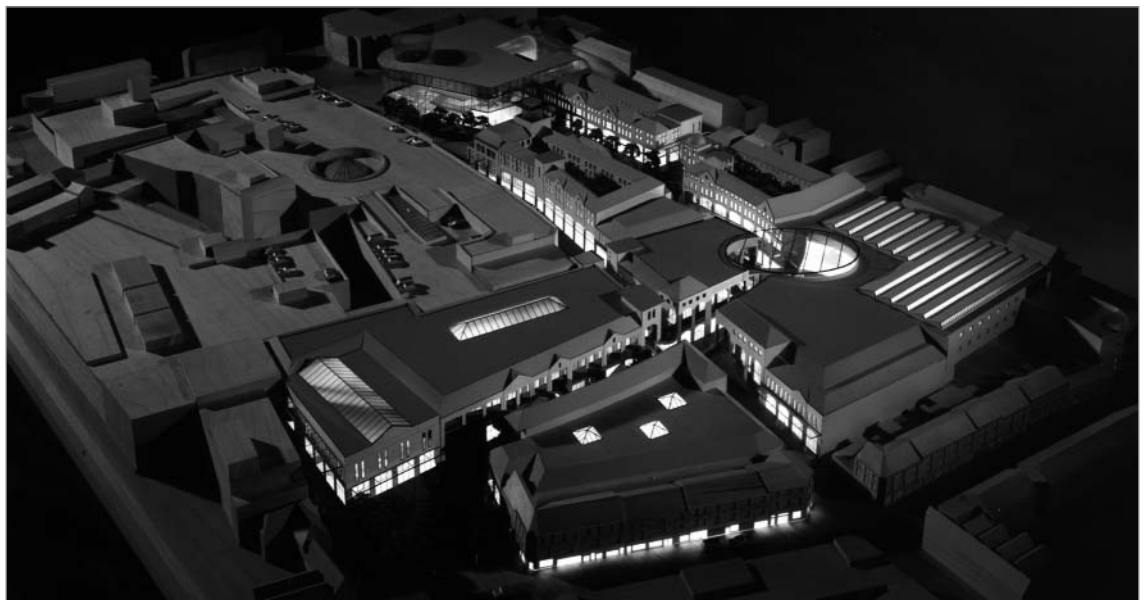

...to Development and Regeneration

politicians pre-occupied with 'more important matters'. It was felt that there was a danger of 'dumbing down' urban design by permitting poor development during an economic downturn which could prove damaging in the longer term. Concerns were expressed about token consultation. Empowered communities added value to development and regeneration.

Several key points arose from facilitated workshops: the potential conflict between the desire to attract development and employment and achieving quality 'place-making' often pits officers against elected Members. Short term deliverability needs to be balanced with a longer-term view and the achievement of lasting value through high quality urban design. The cooling of the market could help us to re-evaluate how we can do things properly, particularly good quality infrastructure as a backbone to urban design. There is a wide 'unconvinced' spectrum, including local communities, developers and politicians. Nobody is

blameless and everybody needs to do better if a decent environment is to be seen as a human right.

In conclusion, despite solid evidence that good design adds value to development and regeneration, the battle is far from won and many remain 'unconvinced'. Developers are still able to make profits by obtaining planning permission for poor quality schemes passing on the costs of poor design on to the community. It is therefore important to raise community and consumer awareness, through media and education, starting in schools, to the important issues involved. People should mandate their elected representatives to take a broader and longer term approach to development and urban design, acting as stewards for the wider public interest, now and for future generations. 🏠

Costas Georghiou

Visiting Professor of Architecture & Urban Design, University of Wolverhampton. Director, CNG Planning Consultancy

Reflections After Three Decades of Planning

Having spent over 30 years as a professional planner, firstly as a gamekeeper in local government, then as a poacher in the development industry and latterly as a gamekeeper back in local government, I have concluded that planning is much harder in the public sector. Modern spatial planning is like cooking but with a difference. You are working with ingredients which are generally not your own, to a recipe usually provided by government and in a kitchen of partnerships where there are thousands of chefs, each trying to leave their particular mark on the cake.

During my career I have seen the status of public sector planners progressively eroded by three key forces.

Firstly, when I started work I was the only planner. Now everybody is a planner. To be frank, when everything is going well, planning is straightforward. But so is chess and there's a world of a difference between playing chess as a grand master and as a rookie. I have tended to earn my crust where the 'quick fix' solutions are not readily apparent and sheer hard work and determination is required to find effective solutions to problems.

Secondly, the profession is becoming increasingly obsessive about process at the expense of product. We are required to leave a written audit trail behind us just in case someone wants to follow in our footsteps. Our ability to exercise professional judgment has been compromised. There is a difference between mediation where we help others to find solutions and arbitration where we offer the solution. You can rest assured that when I am asked to explain to my grandchildren what I did for a living I will not point to the mounds of minutes of meetings or the haystack of LDF documentation, but to where I

have had a hand in bringing about real change on the ground in the creation of vibrant town centres; better communities and improved landscapes.

Finally, no one enters public sector planning to become a millionaire and it remains to be seen how long final salary pension schemes remain in operation. It is galling as a senior manager that at the same time that I am asking staff to perform beyond the call of duty and under pressure to produce spatial planning policy and develop and deliver regeneration schemes, they are also threatened by the implementation in local government of single status schemes with the real prospects of thousands of pounds being docked from their pay. I do not believe that money is a long term motivator for a planning professional but am certain that salary grievances will certainly be an effective disincentive.

In my weaker moments I am resolved that if there is reincarnation I do not intend to come back as a planner. But in truth I think there will always be a continuing role for the profession to act in the public interest and it is incumbent on all senior officers to ensure that the next generation of Patrick Abercrombies and Ebenezer Howards are properly resourced, provided with all the appropriate skills including for practical design and economic appraisal and encouraged to consistently perform up to and sometimes beyond their full potential.

Our legacy will be measured not in the paperwork we leave behind us but in the world we help to create and expect people to live. 🏠

Brian Davies

Planning Policy Manager, Stoke-on-Trent City Council

West Midlands Pilots APC Support Pack for Employers

Chartered Membership of the RTPI is an important professional qualification – not least in this current economic climate when job security is unfortunately less certain than it has been in the past. Your RTPI membership is therefore a portable qualification which sets you apart from other, less highly qualified individuals. As a Chartered Planner you can take pride in what the qualification says about your professional competence – your education and professional training to date, as well as your ongoing commitment to being the best you can be through continuing professional development and adherence to a Code of Professional Conduct. As an employer, employing Chartered Planners gives you this assurance of quality and professionalism.

The route to this professional qualification has undergone some changes in recent years, and since 2006 all new graduates of accredited planning degrees follow the Assessment of Professional Competence (APC) as their route to Chartered Membership. Although some things remain the same – the requirement to gain at least two years of professional planning experience, for example – the APC introduces some new measures which are designed to support graduates in the early years of their professional careers, as well as robustly assess the competence of new entrants to the profession.

While many of us who are existing Chartered Planners are aware that the system has changed, how many of us can say that we fully understand the changes – or, as employers, that we have accommodated the changes into the support we provide for our graduates?

Employers and graduates alike have indicated that there is a lack of information available in many

organisations on what the requirements entail. Although all students are introduced to the process at University, it is clear that support from an employer paves the way for greater chance of success in the future. From an employer's point of view, this means more highly qualified staff; and from the profession's point of view, an increase in standards and professional standing across the board.

It is following such feedback from Members in the West Midlands that the Region has collaborated with the central Membership, Education & Lifelong Learning Department to try to make information more readily available to employers, and ensure that graduates are supported in working towards their professional qualification. If this pilot project is welcomed and is a success, it will be rolled out to other RTPI Regions and Nations.

This information comes in the form of an APC Employer Support Pack, which should be landing on the desks and in the inboxes of your nominated RTPI representative in each organisation. The purpose of the pack is less to provide reams of material to wade through, and more to provide you – employers, members and Licentiates alike – with a 'one stop shop' of all the information and guidance that is available, to access at your leisure. It also includes promotional flyers for use in your office.

If you would like to request a copy of this brief pack, which is available both electronically and in hard copy, please do contact Jacqui Ward, Education Projects Officer, RTPI, 41 Botolph Lane, London EC3R 8DL Email: jacqui.ward@rtpi.org.uk or contact Sue Griffith Jones our Branch Co-ordinator at westmidlands@rtpi.org.uk or ring 0121 709 1599. 

New Regional Manager for Planning Aid

Jon Lord became the new Regional Manager for Planning Aid on 19th January 2009. Jon has joined WMPAS from Walsall Council where he has worked for the last 3 years, although he is not new to Planning Aid having been both a volunteer and member of the Advisory group.

Jon commented "*I've joined WMPAS at a very exciting time of its development. Of course I'm not new to WMPAS. I previously worked as the Urban Project officer from 2001-2004 and I will also be bringing my experiences of implementing the new planning system, having worked as a planning policy officer at Walsall*".

Jon continued "*I intend to build on the tremendous work undertaken by Sandra Newton who has served as acting Regional Manager for the past 18 months, to ensure WMPAS achieves its ambitious targets whilst remaining relevant to the needs of our clients, volunteers and partners. As we move forward, community planning will form one of the main priorities for WMPAS and we will be looking to*

appoint a full time community planner early in 2009 to help deliver planning projects with urban communities in the West Midlands Conurbation".

The Community Planner post partly replaces that held by Malcolm Reid who retired in November and will be in addition to that held by Richard Hammersley, a current part time community planner.

Jon's appointment enables Sandra to return to her role as the full time Planning Advisor. Jon said "*We are very grateful to Sandra and also to Les Greenwood who has been our temporary contract caseworker in recent months and to all the volunteers who have given support for casework particularly when Sandra was covering both roles*".

To complete the team, Gill Wilson was appointed as a full time office administrator in September 2008 and has proved invaluable in ensuring casework and volunteer details are kept up to date. She is the main initial contact for callers and will provide administrative support for our activities. 

CPD ▲ CPD ▲ CPD ▲ CPD ▲ CPD

REGIONAL PROGRAMME

Non-members of RTPI welcome to attend.

THURSDAY 26 FEBRUARY

Renewable Energy Technologies
RTPI & ICE East Midlands event

Programme

National, regional and local policy on renewable energy
Small scale wind turbines
Hydro power
Ground source heat
Biomass
Combined heat and power
Research into low carbon/renewable energy technologies

Speakers to include

Helen Chadwick, East Midlands Regional Assembly
Alex Murley, British Wind Energy Association
Steve Welsh, Water Power Enterprises
Richard Skinner, Ground Source Solutions Ltd
Energy Technologies Institute

Venue: Loughborough University,

Loughborough LE11 3TU

Time: 9.30am – 4pm

Cost: **£97.75 incl. VAT**

Details & Booking: Sue Griffith-Jones

Tel 0121 709 1599

Email: westmidlands@rtpi.org.uk

FRIDAY 13 MARCH

RTPI West Midlands Ball

Venue: Burlington Hotel, **Birmingham B2 4JQ**

Time: 7.30pm

Cost: **£45 per person incl. VAT & £450 for a table (10 max)**

Students & Licentiates £25

Details & Booking: Sue Griffith-Jones

Tel 0121 709 1599

Email: westmidlands@rtpi.org.uk

WEDNESDAY 18 MARCH

Planning Your Future in Planning – Guidance from the RTPI

An event for students, licentiates, mentors & anyone considering a career in planning to find out what the RTPI has to offer & how to become a chartered town planner.

Speaker: **Jacqui Ward, RTPI Lifelong Learning Officer**

Venue: Edge Building, Birmingham City University, Perry Barr, **Birmingham B42 2SU**

Time: 2pm - 5.30pm

Cost: **Free** but booking essential

Details & Booking: Sue Griffith-Jones

Tel 0121 709 1599

Email: westmidlands@rtpi.org.uk

OTHER EVENTS

WEDNESDAY 25 FEBRUARY

Built Environment & Design Fair

Venue: **Birmingham**

Time: 4 – 7pm

Cost: **Free**

Organisers: DEWM

Booking: Register at www.regenwm.org

THURSDAY 5 MARCH

Where evaluation goes wrong

Venue: **Birmingham**

Time: 10am – 1pm

Cost: **£50 + VAT**

Organiser: RegenWM

Details & booking: Tel 021 202 3260

Email: ruth.felce@regenwm.org

TUESDAY 10 MARCH

The role of masterplanning

Venue: Offices of AWM, **Birmingham**

Time: 10am – 4pm

Cost: **£50 + VAT**

Organiser: RegenWM

Details & booking: Tel 021 202 3260

Email: rani.mahey@regenwm.org

TUESDAY 24 – WEDNESDAY 25 MARCH

ParkCity Conference

Venue: **London**

Cost: **£390** for 2 days including gala dinner

Organisers: CABE & Natural England

Details & booking: www.parkcity.org.uk

Plan ahead with Martineau...

Call Clive or Iain on 0870 763 2000
for expert planning & environmental
advice.

martineau



Planning Aid



RTPI

mediation of space · making of place

Planning Aid England is a vibrant and growing voluntary sector service, which aims to empower local communities to effectively engage with the planning process and influence decisions that affect their local area. Following a recent award of substantially increased funding Planning Aid is currently expanding and therefore welcomes applications for the following posts.

COMMUNITY PLANNER £30,456 per annum Full time – 34.5 hours per week. (2 posts) Birmingham

The Role

Providing a free and independent service you will be responsible for identifying and working with eligible community groups and individuals to engage constructively in the planning system. You will be responsible for identifying groups and communities most in need, helping them to better understand planning issues and processes and assisting these groups to develop their own strategies through a range of community planning activities.

The Person

You will have previous community planning experience and you must be able to demonstrate a knowledge and understanding of the needs of diverse groups within communities. The ability to engage and deal sensitively with their needs is paramount to the success of this role. You should enjoy networking and be able to evidence an ability to influence a range of organisations and stakeholders. Excellent communication skills and the ability to effectively manage your workload are therefore essential to this role. You must be a member or eligible for corporate membership of the RTPI and be able to work flexibly (some evenings and weekends). You should possess a degree or post graduate qualification in Town Planning. Post holders are subject to a CRB check.

Please contact recruit@rtpi.org.uk for an Application Form.

The RTPI supports job-sharing and would be happy to receive applications on this basis.

Closing date: 9th February 2009

As a result of increasing recruitment costs and a desire on the part of the RTPI to direct the highest proportion of its financial resources to member driven activities, only those candidates who are required to attend for interview will be contacted after the closing date. If we have not contacted you within a week of the closing date, or any published interview date, we would ask you to assume that your application has not been successful.

tripwire



RTPI West Midlands Ball

Friday 13 March 2009

At the Burlington Hotel 126 New St Birmingham B2 4JQ

Includes a 3 course dinner

'Black tie'

£40 per person incl VAT & £400 for a table (10 max) if payment made before end of January 2009

£45 incl VAT per person, £450 for a table after then

Students & Licentiates £25

From 7.30 pm

Enquiries & bookings: Sue Griffith-Jones
tel: 0121 709 1599

email: westmidlands@rtpi.org.uk



RTPI

mediation of space · making of place

Registered Charity number 262865
Registered Office Address
Royal Town Planning Institute
41 Botolph Lane
London EC3R 8DL



ARUP